

Think GAIA
For Life and the Earth

SANYO

Ultra Portable
Multimedia Projector

PLC-XU106



**Bright,
High Contrast &
Easy Setup for
Business &
Education Use**



Bright: 4,500 Lumens

The PLC-XU106 achieves a high brightness of 4500 lm, and is at the same time compact and lightweight 3.4 kg (7.4 lbs). A contrast ratio of 1000:1 enables the projection of beautiful images. This advanced projector is well suited to wide range of applications such as conferences, classrooms, and meeting rooms. Approaching the brightness of many large, multi-lamp models, this advanced projector is suited to a wide range of applications in conferences, classrooms, and meeting rooms.

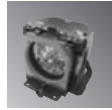

Easy Setup Functions

The PLC-XU106 provides the "Auto Setup Function" to reduce setup time. This function searches for an input signal and detects projector incline to correct vertical shape distortion. In addition, the "Screen Guidance Function" enables projector setup based on the displayed guidance. This function provides all users an easy guide to projection.



Corner Keystone Correction

The Corner Keystone Correction Function eliminates the trapezoidal image distortion that is caused by projection at an angle. Beautiful image projection is possible by adjusting the four corners using the buttons on the main unit or remote control to eliminate trapezoidal distortion.

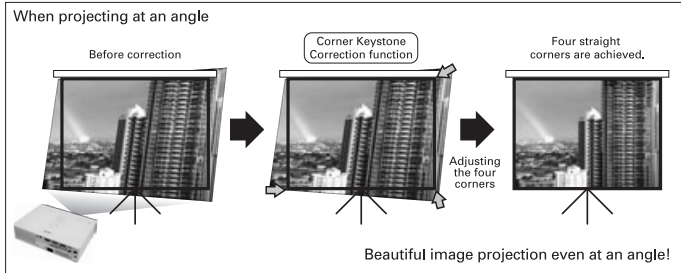

Wide-Range 1.6x Zoom

The wide-range 1.6x zoom lens lets you project a 100" image from as close as 2.4 meters to as far as 3.8 meters from the screen. That makes it a lot easier to find suitable places to set the projector up.

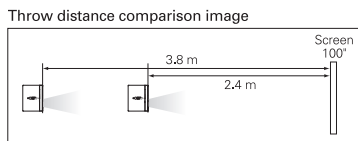

Wired LAN (RJ-45) for projector control

This model is equipped with Wired LAN (RJ-45) to let you to manage and control the projector via network (Browser or PJ Network Manager). You can check the lamp operating time and manage warning notifications by E-mail. You can also control power ON/ OFF and switching of the input signal. This saves management and control time.

360-Degree Tilt Angle

The PLC-XU106 can project images while tilted 360 degrees around the vertical axis in either direction, allowing more flexible setup.

NOTE: When the projector is inclined to more than +40 degrees and less than -140 degrees from the horizontal plane, be sure to set the lamp control to High and the fan control to MAX in the setting menu.

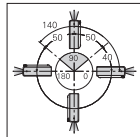

Other Features

- PJ Link compatibility
- Auto Keystone Correction (vertical)
- Keystone Correction (vertical, horizontal)
- 17-Language on-screen menu
- User logo (screen capture)
- No show
- Freeze
- Presentation timer



All products manufactured by the Projector Division of SANYO's Digital System Company employ a quality management system that has undergone the inspection and registration process of the ISO 9001 international standard.

Specifications

Model name	PLC-XU106			
Panel	0.8 inch TFT p-Si x 3 with Micro Lens			
No. of pixels	2,359,296 (1024 x 768 dots) x 3			
Projection lamp	275W NSHA			
Brightness*1 (typical)	4500 lm (Lamp modes: "High" & "Dynamic mode")			
Contrast*	1000:1 (Lamp modes: "High" & "Dynamic mode")			
Uniformity*1	85 % (corner to center)			
Projection lens	F1.7 - 2.5, f = 19.2 - 30.2 mm (0.8 - 1.2 inches)			
Screen size	40" - 300", U:D = 9:1			
Throw distance	0.9 m (wide) - 11.5 m (tele), (3.0 - 37.7 ft), 100" at 2.4 - 3.8 m (7.9 - 12.5 ft)			
Zoom / Focus	1:1.6 Manually driven			
SD/HD/TV signals	480i, 480p, 575i, 575p, 720p, 1035i and 1080i			
Color systems	PAL / SECAM / NTSC / NTSC4.43 / PAL-M/N			
Video signal	Composite, S-Video, D-sub 15-pin for Component			
Video terminal	RCA: Composite Video Mini-DIN 4-pin: S-Video			
Computer compatibility	WUXGA/UXGA/WXGA+/SXGA+/SXGA/WXGA+/MXGA/XGA/SVGA/VGA			
Computer terminal	D-sub15 x 2 for input, D-sub15 for monitor output			
Audio	RCA (L/R) for video input Mini-Jack (Stereo) x 2 for computer input Mini-Jack (Stereo) for output (variable)			
Communication terminals	RJ-45 (Wired LAN), D-sub9 (RS-232C)			
Presentation tools	Freeze / Digital Zoom / No Show / etc.			
Other Features	Progressive, 3-2 & 2-2 pull down, LTI & CTF*, User Logo Security: PIN code lock, Key lock			
Scanning frequency	H sync 15 - 100 kHz, V sync 50 - 100 Hz, Dot clock 140 MHz			
Sound output	1.0 W Mono			
Voltage	100 V - 240 V AC (auto voltage)			
Power consumption	100 - 120V	354 W (High) / 327 W (Normal) / 284 W (Eco); Standby: 8.0 W (Network) / 0.5 W (Eco)	200 - 240V	332 W (High) / 306 W (Normal) / 269 W (Eco); Standby: 9.8 W (Network) / 0.9 W (Eco)
Dimensions (W x H x D) (not including protruding parts)	334.2 x 78.4 x 257.5 mm (13.1 x 3.1 x 10.1 inches)			
Weight	3.4 kg (7.4 lbs)			
Main accessories	Quick reference guide, user's manual (CD ROM), CD-ROM read me note, PIN code label, computer cable (Dsub15toDsub15), power cord (detachable) remote control, AAA batteries x 2, PJ Network Manager software (CD ROM), strap for lens cap, soft carrying bag			

* Replacement Lamp Type No: POA-LMP111
*1 Measurement, measuring conditions, and method of notation all comply with ISO 21118 international standards. Product names and company names are trademarks or registered trademarks of their respective companies.
*2 Luminance Transient Improvement (LTI) and Color Transient Improvement (CTI) sharpen the detail.
* All product names and company names are trademarks or registered trademarks of their respective companies.
* Product design and specifications are subject to change without notice.

Terminals



Remote control



External dimensions (units: mm(inch))

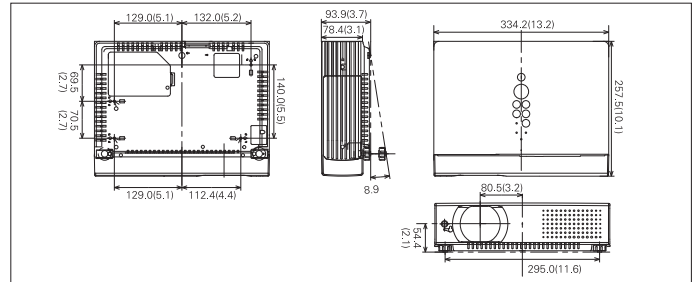

Approximate throw distance / picture size (1.6x zoom)

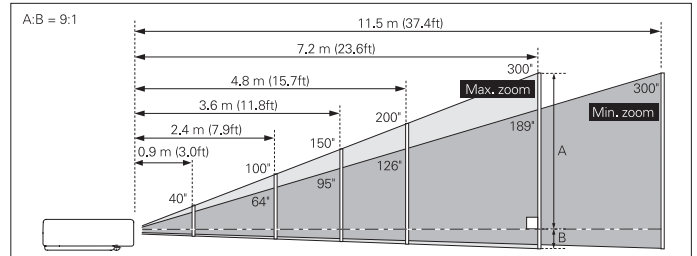

Screen size (W x H) mm	40"	100"	150"	200"	300"
4:3 aspect ratio	813 x 610	2032 x 1524	3048 x 2286	4064 x 3048	6096 x 4572
Tele	1.5m (4.9ft)	3.8 m (12.5ft)	5.7 m (18.7ft)	7.6 m (24.9ft)	11.5m (37.4ft)
Wide	0.9m (3.0ft)	2.4 m (7.9ft)	3.6 m (11.8ft)	4.8 m (15.7ft)	7.2 m (23.6ft)



SANYO's Digital System Company has received ISO 14001 certification for the environmental management system used in its factory.



Pixelworks ICs are used in this projector

<http://www.sanyo-lcdp.com>

Caution: Please consult the instruction manual to ensure safe and proper operation of the product.

Distributed by:



SANYO Electric Co., Ltd.
Digital System Company

© 2009 SANYO Printed in Japan 2009.9 NP.
SML141